

A2INU SIZE: 1/4" ~ 2"



- *STAINLESS STEEL
 - AISI-316 (DIN 1.4408) (ASTM-A351-CF8M)
 - AISI-304 (DIN 1.4301) (ASTM-A351-CF8)
- *CARBON STEEL
 - S-45C (Din 1.0619) (ASTM-A216-WCB)

FEATURES:

- *Pipe thread in accordance with ANSI B2.1, BS 21 1973, DIN 259/2999, ISO 228
- *800PSI (55BAR) W.O.G./ 1000PSI (69BAR) W.O.G
- *Blow-out proof stem / Full port
- *Investment casting body and cap
- *Material:ASTM-351-CF8M; ASTM-351-CF8 & ASTM-A216-WCB
- *ROHS

MATERIALS LIST

| ITEM | PARTS | QTY | MATERIALS | | |
|------|---------------|-----|----------------|----------------|----------------|
| | | | 316 | 304 | WCB |
| 1 | BODY | 1 | ASTM-A351-CF8M | ASTM-A351-CF8 | ASTM-A216-WCB |
| 2 | CAP | 1 | ASTM-A351-CF8M | ASTM-A351-CF8 | ASTM-A216-WCB |
| 3 | BALL | 1 | ASTM-A351-CF8M | ASTM-A351-CF8M | ASTM-A351-CF8M |
| 4 | BALL SEAT | 2 | PTFE | PTFE | PTFE |
| 5 | JOINT GASKET | 1 | PTFE | PTFE | PTFE |
| 6 | STEM | 1 | S.S.316 | S.S.316 | S.S.316 |
| 7 | THRUST WASHER | 1 | PTFE | PTFE | PTFE |
| 8 | STEM PACKING | 2 | PTFE | PTFE | PTFE |
| 9 | NUT | 1 | S.S.304 | S.S.304 | S.S.304 |
| 10 | HANDLE | 1 | S.S.430 | S.S.430 | S.S.430 |
| 11 | SPRING WASHER | 1 | S.S.304 | S.S.304 | S.S.304 |
| 12 | STEM NUT | 1 | S.S.304 | S.S.304 | S.S.304 |
| 13 | PLASTIC | 1 | P.V.C | P.V.C | P.V.C |
| 14 | SHIM | 1 | S.S.304 | S.S.304 | S.S.304 |
| 15 | B.V. WASHER | 2 | S.S.301 | S.S.301 | S.S.301 |

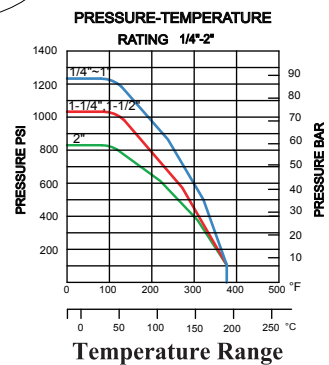
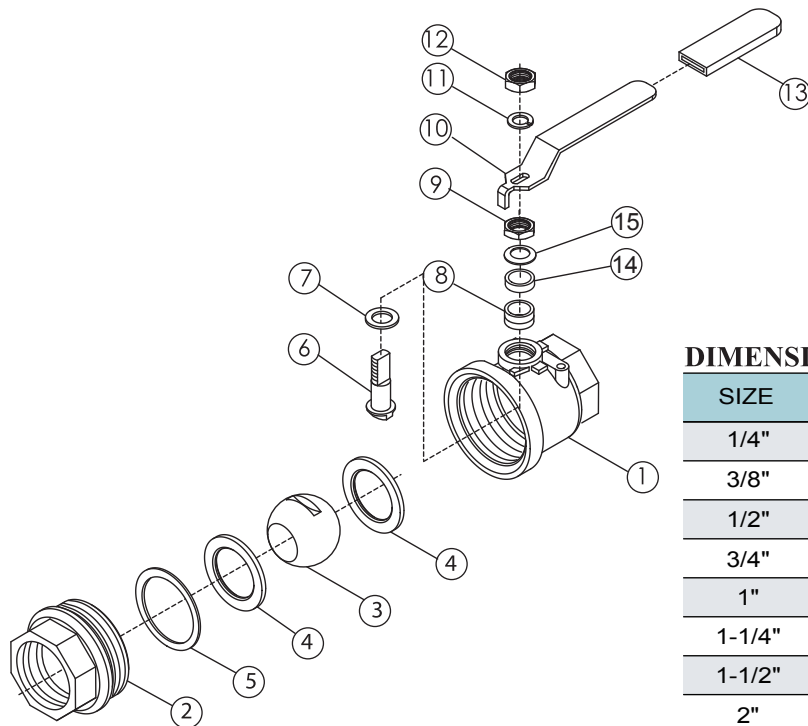
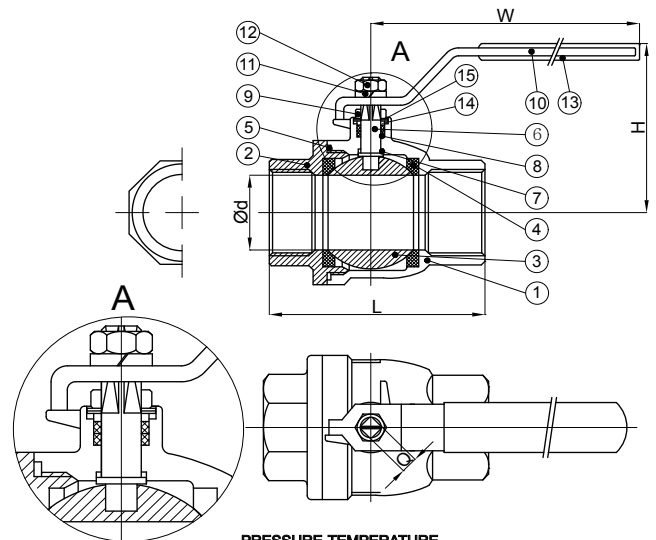

DIMENSIONS

| SIZE | Ød | L | H | W | Q | UNIT:mm | |
|--------|------|-----|-----|-----|-----|-----------|---------------|
| | | | | | | Cv FACTOR | TORQUE kgf-cm |
| 1/4" | 11.6 | 50 | 50 | 100 | 9.0 | 6.6 | 40 |
| 3/8" | 12.7 | 50 | 50 | 100 | 9.0 | 7.9 | 40 |
| 1/2" | 15 | 62 | 53 | 100 | 9.0 | 11.2 | 54 |
| 3/4" | 20 | 73 | 63 | 130 | 11 | 21 | 74 |
| 1" | 25 | 75 | 67 | 130 | 11 | 35 | 104 |
| 1-1/4" | 32 | 98 | 75 | 150 | 11 | 57 | 135 |
| 1-1/2" | 38 | 108 | 81 | 150 | 14 | 80 | 180 |
| 2" | 50 | 124 | 102 | 200 | 14 | 148 | 250 |