

A3NS SIZE: 1/4" ~ 4" **HOT**



STAINLESS STEEL
 AISI-316 (DIN 1.4408) (ASTM-A351-CF8M)
 AISI-304 (DIN 1.4308) (ASTM-A351-CF8)
 CARBON STEEL
 S-45C (DIN 1.0619) (ASTM-A216-WCB)

FEATURES:

- *Pipe thread in accordance with ANSI B2.1, BS 21:1973, DIN 259/2999, ISO 228
- *Pressure rating: 1000 PSI (63 BAR)
- *Investment casting body and cap
- *Blow-out proof stem
- *Screwed end / Butt weld end / Socket weld end
- *Lug body

OPTION:

- *Locking device
- *Anti-static device
- *Reduced port
- *Fire-safe design

MATERIALS LIST

ITEM	PARTS	QTY	MATERIALS		
			316	304	WCB
1	BODY	1	ASTM-A351-CF8M	ASTM-A351-CF8	ASTM-A216-WCB
2	CAP	2	ASTM-A351-CF8M	ASTM-A351-CF8	ASTM-A216-WCB
3	BALL	1	ASTM-A351-CF8M	ASTM-A351-CF8	ASTM-A351-CF8
4	BALL SEAT	2	PTFE	PTFE	PTFE
5	STEM	1	AISI 316	AISI 304	AISI 304
6	THRUST WASHER	1	PTFE	PTFE </td <td>PTFE</td>	PTFE
7	STEM PACKING	2	PTFE	PTFE	PTFE
8	GLAND NUT	1	AISI 304	AISI 304	AISI 304
9	HANDLE	1	AISI 430	AISI 430	AISI 430
10	STEM WASHER	1	AISI 304	AISI 304	AISI 304
11	STEM NUT	1	AISI 304	AISI 304	AISI 304
12	PLASTIC COVER	1	P.V.C	P.V.C	P.V.C
13	LOCK DEVICE	1	AISI 430	AISI 430	AISI 430
14	BOLT	4(3",4"x6 PCS)	AISI 304	AISI 304	AISI 304
15	SPRING WASHER	8(2-1/2"x8PCS 3",4"x12PCS)	AISI 304	AISI 304	AISI 304
16	HEX NUT	8(2-1/2"x8PCS 3",4"x12PCS)	AISI 304	AISI 304	AISI 304

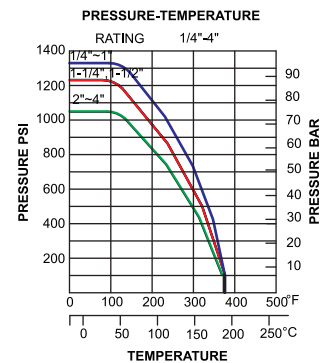
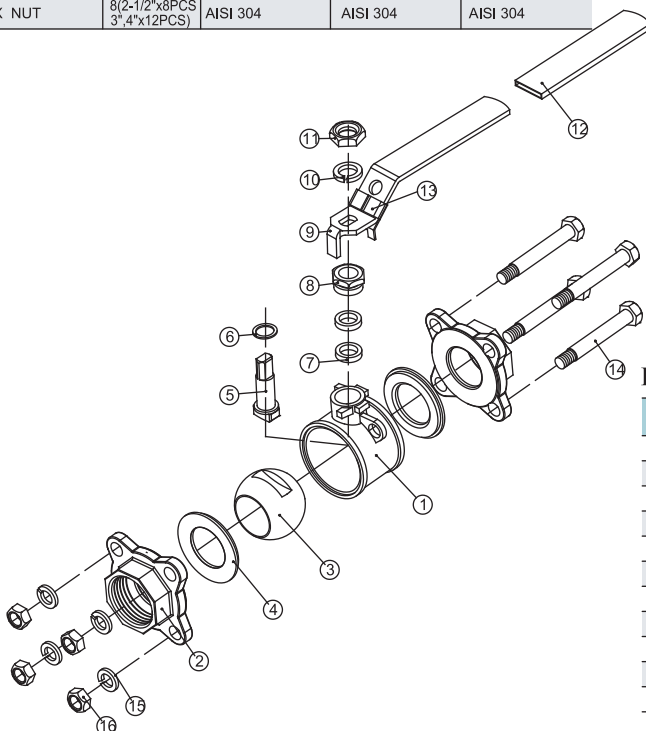
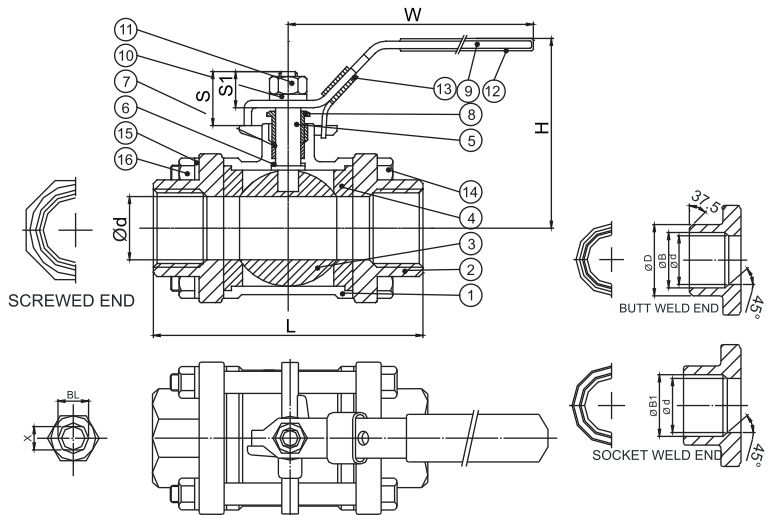

DIMENSIONS

NOMINAL SIZE	Ød	L	H	W	ØB	ØD	ØB1	S	S1	X	BL	UNIT:mm	
												Cv FACTOR	TORQUE kgf-cm
1/4"	11.6	46	47	76	11.6	18	14.1	14	8	4	M6X1	6.6	36
3/8"	12.8	46	47	76	14	18	17.6	14	8	4	M6X1	7.9	36
1/2"	15	58	49	85	17.1	22	21.7	16	10	5	M8X1.25	11.2	49
3/4"	20	70	60	95	22.5	27.5	27.1	17	10	5	M8X1.25	21	70
1"	25	76	68	120	28	33.5	33.8	21	12	6.5	M10X1.5	34	95
1-1/4"	32	86	73	120	35.5	44	42.6	18	12	6.5	M10X1.5	57	135
1-1/2"	38	101	83	155	43	50	48.7	25	14	8.5	M12X1.75	80	180
2"	50	115	91	155	53	61.5	61.1	22	14	8.5	M12X1.75	148	252
2-1/2"	65	150	122	215	65	76	76.9	36	27	12	M18X2.5	265	432
3"	80	168	132	215	80	92	89.5	35	27	12	M18X2.5	415	675
4"	100	200	160	300	100	115	115.5	41	31	15	M22X1.5	780	990