

# 2-PC Full Port Ball Valve Screwed End



**HIGH PRESSURE (2000 PSI)**

V2 SIZE: 1/4" ~ 2"



STAINLESS STEEL  
 AISI-316 (DIN 1.4408) (ASTM-A351-CF8M)  
 AISI-304 (DIN 1.4308) (ASTM-A351-CF8)  
 CARBON STEEL  
 S-45C (DIN 1.0619) (ASTM-A216-WCB)

**FEATURES:**

- \*Pipe thread in accordance with ANSI B2.1, BS 21:1973, DIN 259/2999, ISO 228
- \*Investment casting body and cap
- \*Pressure rating: 2000 PSI (130 BAR)
- \*Blow-out proof stem
- \*With mounting pad
- \*Lug body

**OPTION:**

- \*Locking device

**MATERIALS LIST**

ITEM	PARTS	QTY	MATERIALS		
			316	304	WCB
1	PLASTIC COVER	1	PC	PC	PC
2	HANDLE	1	AISI430	AISI430	AISI430
3	STEM	1	CF8M	CF8	CF8
4	NUT	1	AISI304	AISI304	AISI304
5	SPRING WASHER	1	AISI304	AISI304	AISI304
6	GLAND	1	AISI304	AISI304	AISI304
7	STEM PACKING	2	PTFE	PTFE	PTFE
8	THRUST WASHER	1	PTFE	PTFE	PTFE
9	GASKET	1	PTFE	PTFE	PTFE
10	BALL SEAT	2	25%GF +PTFE	25%GF +PTFE	25%GF +PTFE
11	BALL	1	CF8M	CF8	CF8
12	CAP	1	CF8M	CF8	WCB
13	BODY	1	CF8M	CF8	WCB

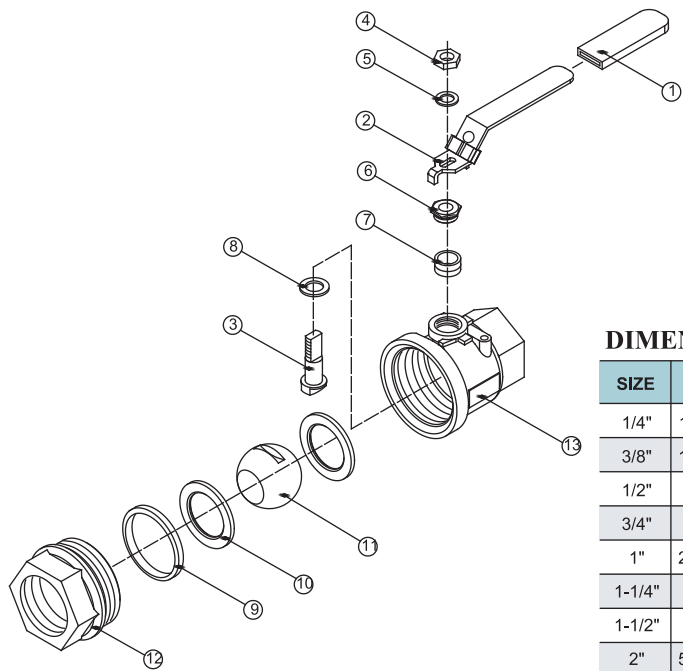
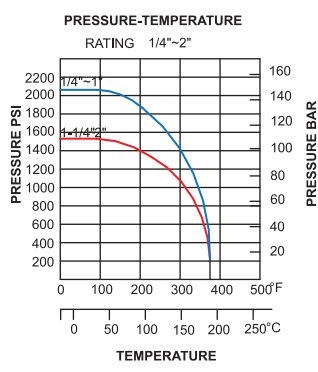
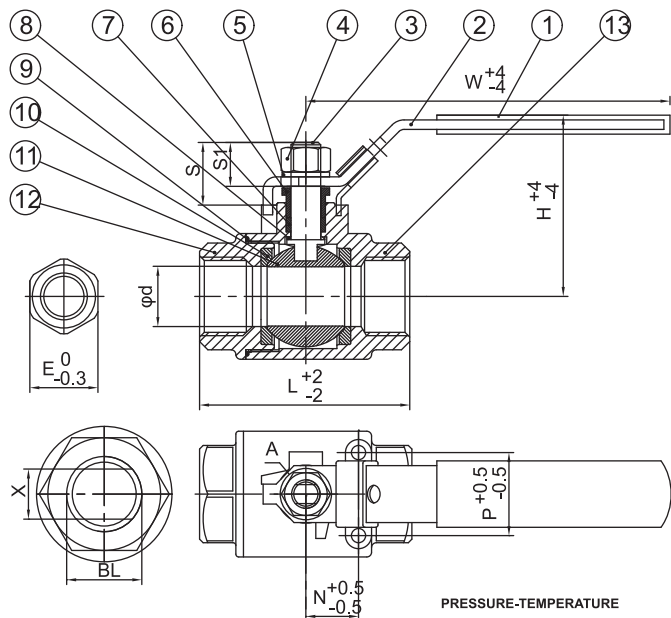

**DIMENSIONS**

SIZE	Ød	L±2	H±4	W±4	S	S1	X	N	P	E	BL	CV FACTOR	UNIT:mm	
													TORQUE N/m	KGS
1/4"	11.6	58	54	98	19	12	5.8	12.5	28.5	25	M8	6.6	--	--
3/8"	12.7	58	54	98	19	12	5.8	12.5	28.5	25	M8	7.9	--	--
1/2"	15	60.5	54	98	19	12	5.8	12.5	28.5	28	M8	11.2	4.0	0.356
3/4"	20	76	67	120	23	14.5	7.0	20.5	35	34	M10	21	--	--
1"	25.4	89	76	154	26.5	18.5	8.0	22.5	35	41	M12	35	--	--
1-1/4"	32	100	82	154	24.5	18.5	8.0	23.5	38	51	M12	57	--	--
1-1/2"	38	118.5	90.5	184	26	18.5	8.0	23.5	38	57.5	M12	80	--	--
2"	50.8	140	94	184	26	18.5	8.0	35.5	38	73.5	M12	150	--	--