

# 2-PC Mounting Pad Full Port Ball Valve Screwed End



V2HP SIZE: 1/4" ~ 2"

**NEW**

**HIGH PRESSURE (6000 PSI)**



**STAINLESS STEEL**  
 AISI-316 (DIN 1.4408) (ASTM-A351-CF8M)  
 AISI-304 (DIN 1.4308) (ASTM-A351-CF8)  
**CARBON STEEL**  
 S-45C (DIN 1.0619) (ASTM-A216-WCB)

**FEATURES:**

- \*Pipe thread in accordance with ANSI B2.1, BS 21:1973, DIN 259/2999, ISO 228
- \*In accordance with ANSI Class 2500 standard
- \*Investment casting body and cap
- \*Pressure rating: 6000 PSI (400 BAR)
- \*Blow-out proof stem
- \*ISO 5211 mounting pad
- \*Fire-safe design
- \*Anti-static device
- \*Lug body

**OPTION:**

- \*Locking device
- \*No mounting pad

**MATERIALS LIST**

ITEM	PARTS	QTY	MATERIALS		
			316	304	WCB
1	BODY	1	ASTM-A351-CF8M	ASTM-A351-CF8	ASTM-A216-WCB
2	INSERT	1	ASTM-A351-CF8M	ASTM-A351-CF8	ASTM-A216-WCB
3	SCREWED CAP	1	ASTM-A351-CF8M	ASTM-A351-CF8	ASTM-A216-WCB
4	BALL	1	ASTM-A351-CF8M	ASTM-A351-CF8	ASTM-A351-CF8
5	BALL SEAT	2	PEEK	PEEK	PEEK
6	SEAL	1	PTFE	PTFE	PTFE
7	GASKET	1	PTFE	PTFE	PTFE
8	STEM	1	AISI 316	AISI 304	AISI 304
9	STEM PACKING	2	PTFE	PTFE	PTFE
10	THRUSE WASHER	1	PTFE	PTFE	PTFE
11	GLAND NUT	1	AISI 304	AISI 304	AISI 304
12	HANDLE	1	AISI 304	AISI 304	AISI 304
13	STOPPER 2	1	AISI 304	AISI 304	AISI 304
14	LOCK DEVICE	1	AISI 304	AISI 304	AISI 304
15	HANDLE NUT	1	AISI 304	AISI 304	AISI 304
16	O-RING	1	VITON	VITON	VITON
17	BUSH	1	PTFE	PTFE	PTFE

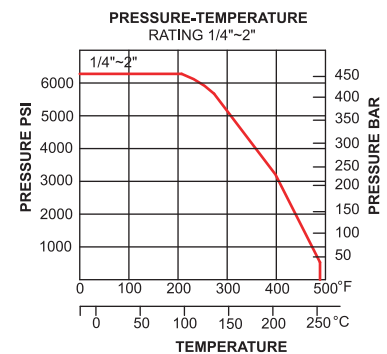
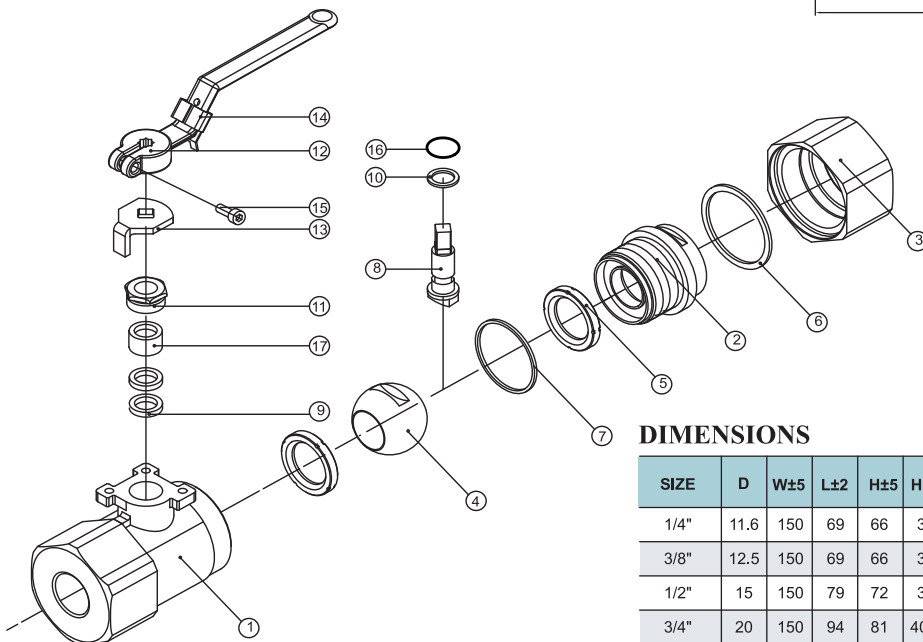
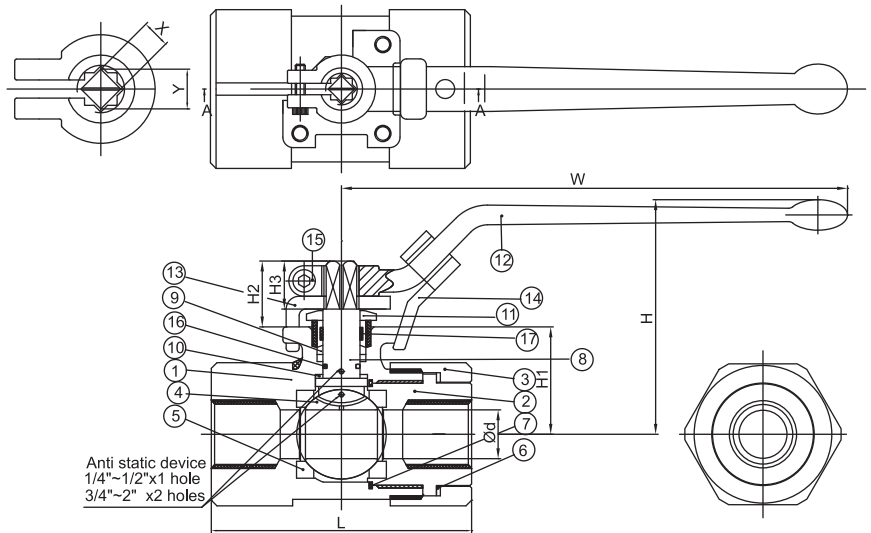

**DIMENSIONS**

SIZE	D	W±5	L±2	H±5	H1±1	H2±1	H3±1	X	Y	ISO 5211	Cv FACTOR	TORQUE kgf-cm	KGS	
1/4"	11.6	150	69	66	30	14.4	10.9	7.0	9.0	F03 Ø36	6.6	60	35	0.71
3/8"	12.5	150	69	66	30	14.4	10.9	7.0	9.0	F03 Ø36	7.9	75	50	0.71
1/2"	15	150	79	72	33	17.4	10.9	7.0	9.0	F03 Ø36	11.2	75	50	0.96
3/4"	20	150	94	81	40.8	17.4	10.9	7.0	9.0	F03 Ø36	21	150	90	1.87
1"	25	180	120	105	46	23	16	11	14	F04 Ø42	35	220	130	2.82
1-1/4"	32	180	130	115	55	24	16	11	14	F05 Ø50	57	250	150	4.39
1-1/2"	38	235	149	125	67.5	29	21	17	22	F07 Ø70	80	400	240	9.21
2"	50	235	174	135	76.5	28.5	21	17	22	F07 Ø70	150	550	330	13.53

UNIT:mm